

P:\2025\25-024 ROWAN GIS ROUND 5\DRAWINGS\CONDOS\ADDENDUMS & BUILDING SECTIONS\12/23/2025 11:19:44 AM

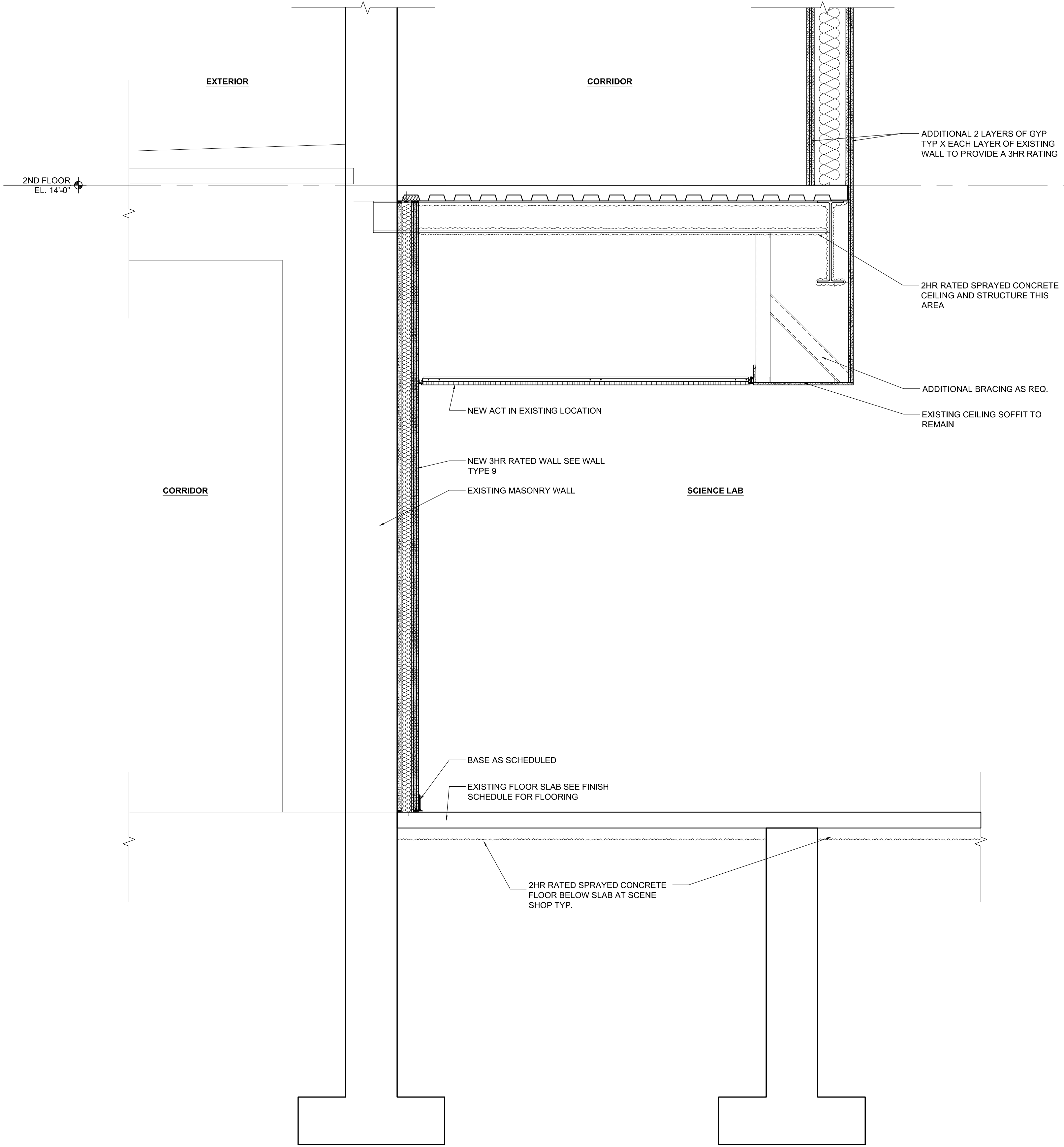

1 SECTION THRU SCENE SHOP AND CORRIDOR
SCALE: 3/4" = 1'-0"

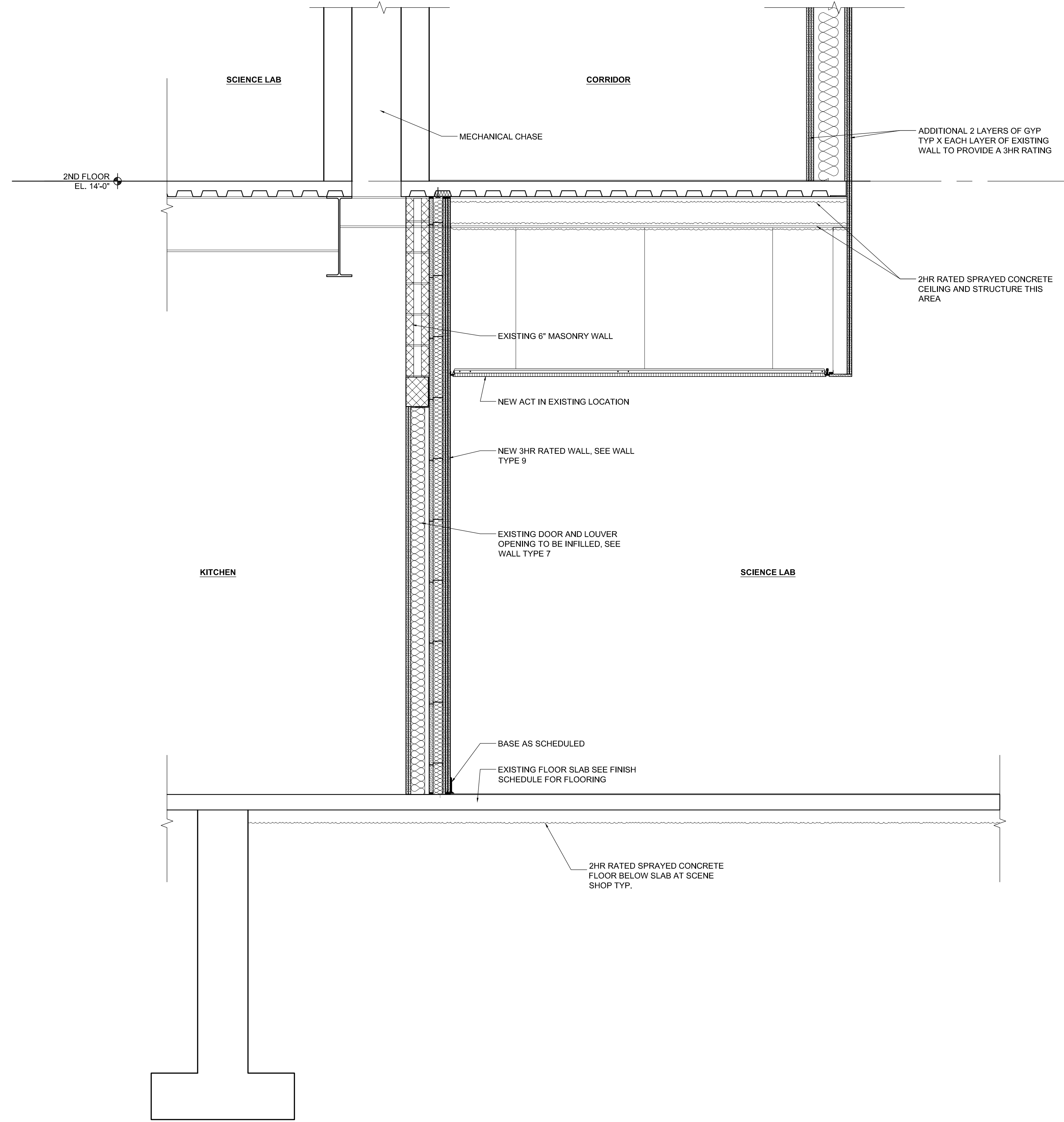

2 SECTION THRU SCENE SHOP AND KITCHEN
SCALE: 3/4" = 1'-0"

KEY PLAN:

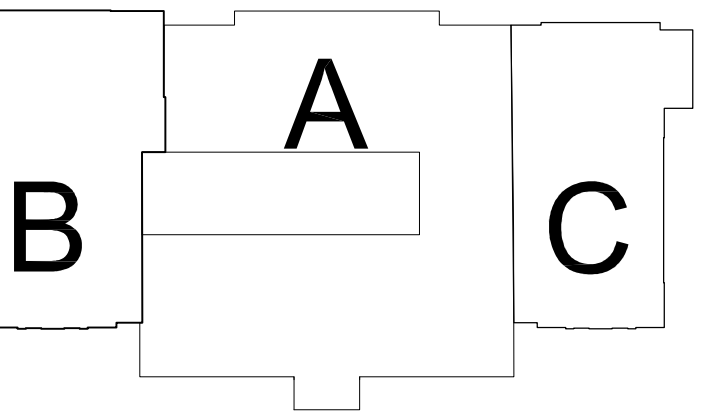

#1	12/23/25	ADDENDUM #1
	12/09/25	OUT TO BID
	12/03/25	DCA Submission
No.	Date	Description
Revisions / Issues		

DiGroupArchitecture
ARCHITECTURE FOR CHANGE

15 Bethany Street • New Brunswick, NJ 08901 • T:732.249.6242
2450 W Hunting Park Ave., Bldg 9 • Philadelphia, PA 19129-1302 • T:215.634.3400

Richard D. Alderiso, AIA
NJ RA A1 15023, NY RA 027416, PA RA 405474

DO NOT SCALE. DRAWING MAY BE PRINTED AT REDUCED SCALE. CONSULT WITH ARCHITECT FOR DIMENSIONS.

Client:
Rowan University
201 Mullica Hill Rd.
Glassboro, NJ 08028

Project:
Alterations to Facility Located at 202 Delsea Drive
BLOCK 26 / LOT 412
202 Delsea Dr.
Glassboro, NJ 08028

Drawing Information:
Project No: 25.024
Date: 04/09/2025
Drawn By: TC
Checked By: KG

Sheet Name:
SCENE SHOP SECTIONS

Sheet No:

A-205
Sheet 0 of 000